

File Name: S:\\_2017\217-0005\0HY\Road\CAD\WOT\Sht\_Detours.dwg Plot Date: 12/20/2022 Plotted By: Tedder, Katelyn

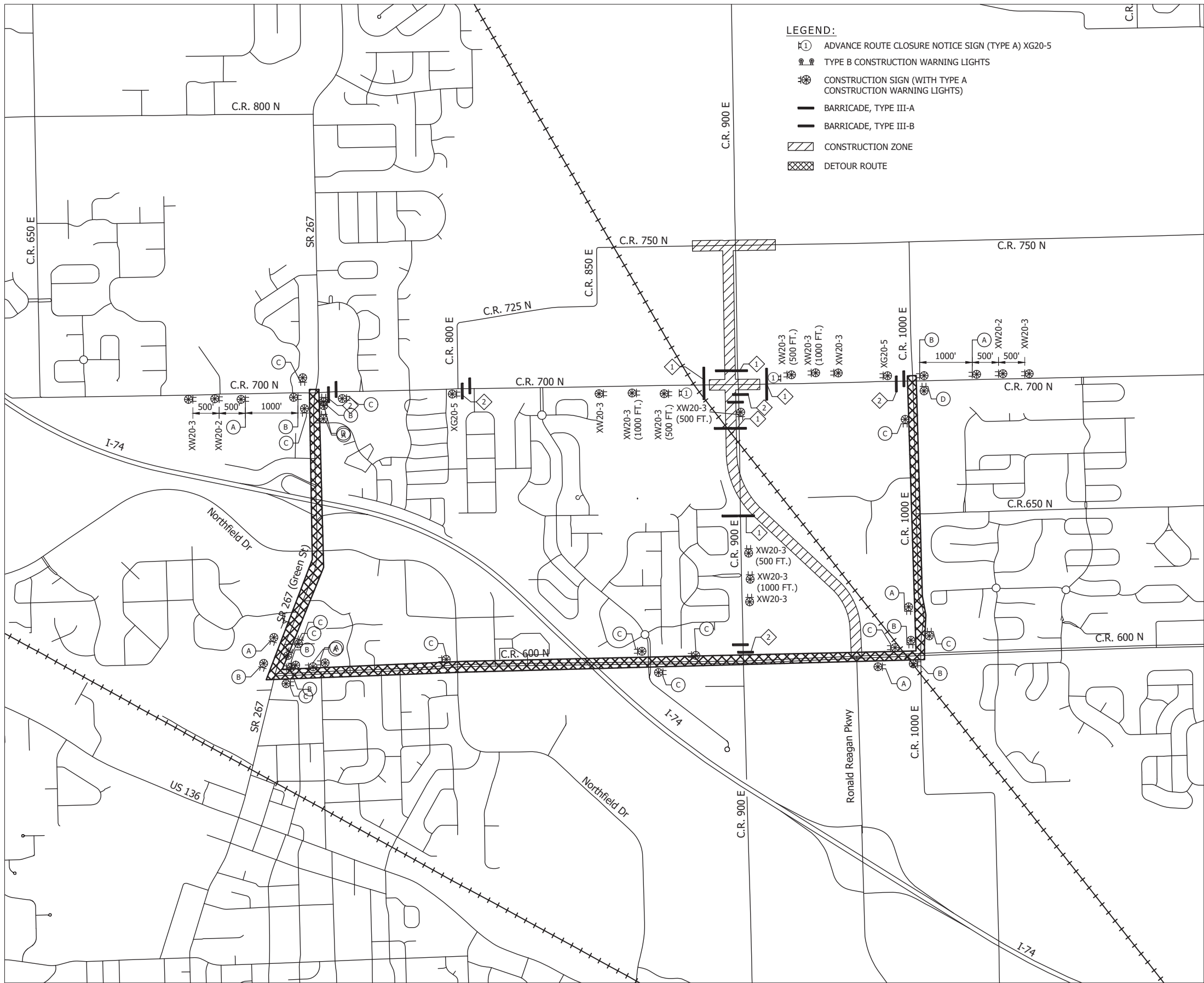

CONSTRUCTION SIGN SCHEDULE				
SIGN NO.	DESCRIPTION	SIZE (IN)	TYPE	EST. QTY.
XW20-2	"DETOUR AHEAD" SIGN	48 x 48	A	2
XW20-3	"ROAD CLOSED AHEAD" SIGN	48 x 48	A	6
XW20-3 (1000 FT.)	"ROAD CLOSED 1000 FT" SIGN	48 x 48	A	4
XW20-3 (500 FT.)	"ROAD CLOSED 500 FT" SIGN	48 x 48	A	4
XG20-5 (1)	ADVANCE ROUTE CLOSURE NOTICE SIGN (C.R. 700 N)	60 x 36	A	2
TOTAL TYPE "A" SIGNS				18

DETOUR ROUTE MARKER ASSEMBLIES: 23 EACH  
ROAD CLOSURE SIGN ASSEMBLY: 12 EACH  
TYPE III-A BARRICADES: 348 LFT.  
TYPE III-B BARRICADES: 120 LFT.

- 1 Road Closure Sign Assembly with Type A Barricades  
(13 x 12 = 156 LFT), R11-2 and XM4-10 (R) or (L)
- 2 Road Closure Sign Assembly with Type B Barricades  
(10 x 12 = 120 LFT), R11-4 and XM4-10 (R) or (L)

LEGEND

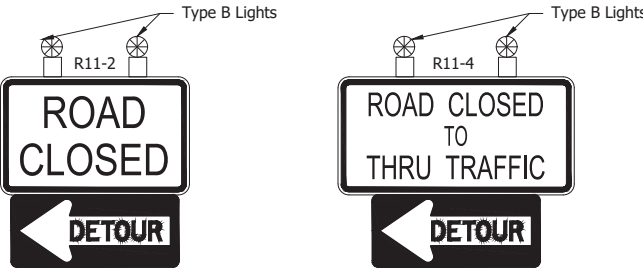
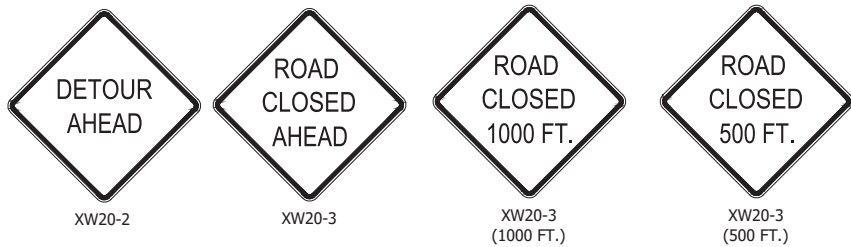
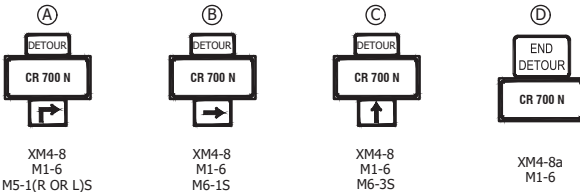

ROAD CLOSURE SIGN ASSEMBLY 1

ROAD CLOSURE SIGN ASSEMBLY 2

GENERAL NOTES

- ALL MAINTENANCE OF TRAFFIC DEVICES, SIGNS AND PAVEMENT MARKINGS SHALL CONFORM TO THE LATEST EDITION OF THE INDIANA MUTCD.
- SEE INDOT STD DWG 801-TCDD-01 FOR ADDITIONAL DETAILS.
- SEE INDOT STD DWG 801-TCLG-01 FOR GENERAL NOTES.
- ACCESS SHALL BE MAINTAINED FOR LOCAL BUSINESSES AND RESIDENTS AT ALL TIMES.
- C.R. 700 N AND C.R. 750 N SHALL NOT BE CLOSED AT THE SAME TIME.
- XG20-5 (ROAD CLOSED ON OR AFTER \_\_\_\_\_) SIGNS SHALL BE PLACED A MINIMUM OF 14 CALENDAR DAYS PRIOR TO ANY ROAD CLOSURE.
- BARRICADE III-A = 192 LFT AND 2 ROAD CLOSURE SIGN ASSEMBLIES ARE INCLUDED IN THE QUANTITIES TO BARRICADE RONALD REAGAN PARKWAY WHEN NOT WORKING.



RECOMMENDED FOR APPROVAL	DESIGN ENGINEER	DATE
DESIGNED: JNH	DRAWN: JNH	12/21/2022
CHECKED: BKA	CHECKED: BKA	

INDIANA  
DEPARTMENT OF TRANSPORTATION  
MAINTENANCE OF TRAFFIC  
CR700N DETOUR

HORIZONTAL SCALE	BRIDGE FILE
1" = 1000'	32-00089
VERTICAL SCALE	DESIGNATION
N/A	1602280
SURVEY BOOK	SHEETS
ELECTRONIC	9 of 169
CONTRACT	PROJECT
R-44754	1602280