

ROAD CLOSURE

NOTICE DATE: August 27, 2024
ATTENTION: Plainfield
OVERVIEW: **Stafford Road - 9/3/24 thru Fall ~~2024~~ - Bridge 237**

DETAILS

PROJECT: **Bridge 237**
CLOSURE ROAD: Stafford Road (E CR 450 S) between S Ronald Reagan & Bridgeport Road
CLOSURE DATES: Tuesday, September 3, 2024, through Fall ~~2024~~ **2025**
DETAILS: Full road closure
MAPS: Detour & Actual Location Maps Attached
EMERGENCY VEHICLES: No

Best Regards,

A handwritten signature in black ink that reads "Curt Higginbotham".

Curt Higginbotham, Superintendent
Hendricks County Highway Department
930 E Main Street
Danville, IN 46122
chigginbotham@co.hendricks.in.us
(317) 745-9227

Contractor: Reith Riley

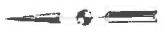

END CONSTRUCTION
 XG20-2A
 60" x 24"

SPEEDING
 MAX. \$1000
 RECKLESS DRIVING
 MAX. 6 YRS
 XMG-5-A
 72" x 48"

CONSTRUCTION SIGNS, TYPE "A"

ROAD CLOSED
 X.X MILES AHEAD
 LOCAL TRAFFIC ONLY
 R11-3
 60" x 30"

ROAD CLOSED
 R11-2
 48" x 30"

ROAD CLOSURE SIGN ASSEMBLIES

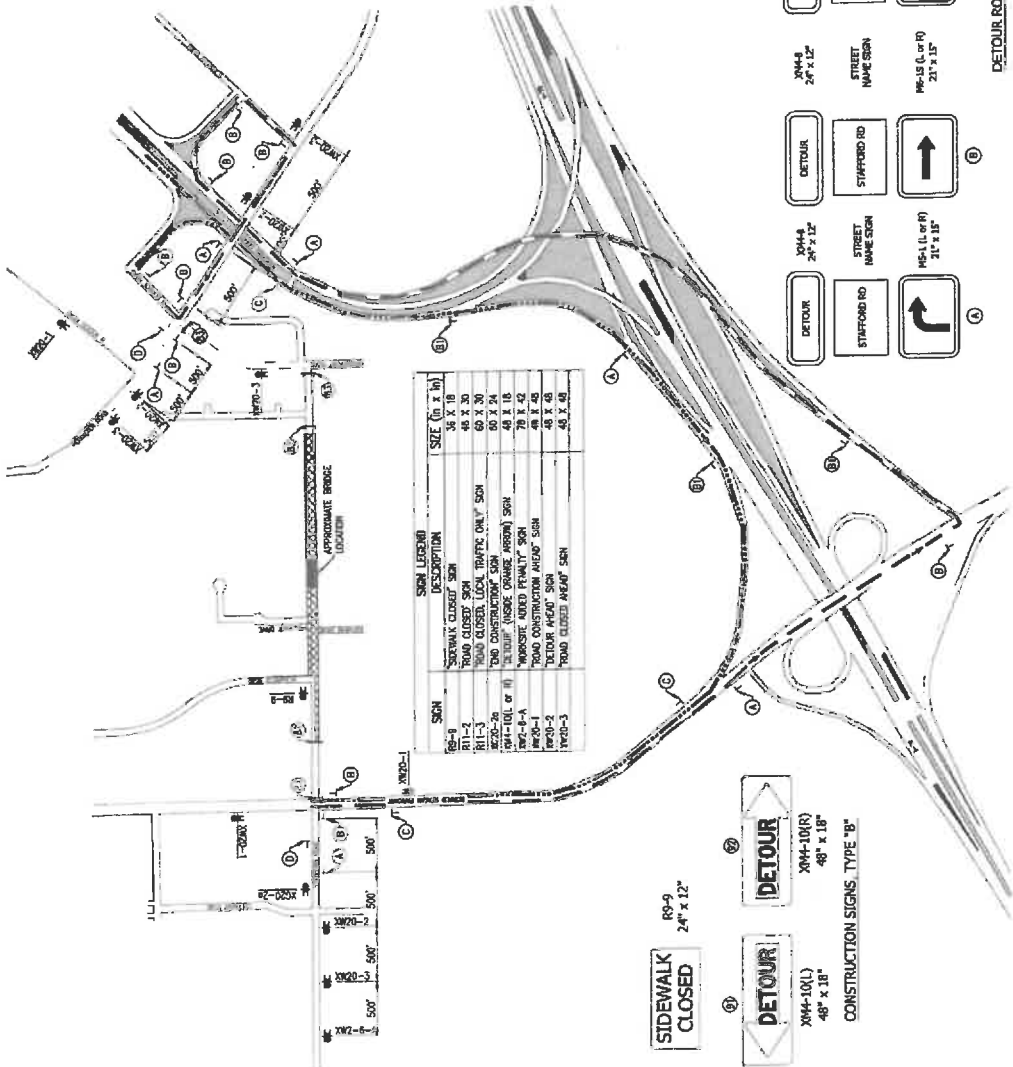

| SYMBOL | DESCRIPTION | SIZE (H x W) |
|-----------|--|--------------|
| R9-9 | SIDEWALK CLOSED SIGN | 24" x 12" |
| XMG-10(L) | DETOUR SIGN | 48" x 18" |
| XMG-10(R) | DETOUR SIGN | 48" x 18" |
| R11-3 | ROAD CLOSED LOCAL TRAFFIC ONLY SIGN | 60" x 30" |
| R11-2 | ROAD CLOSED SIGN | 48" x 30" |
| XG20-2A | END CONSTRUCTION SIGN | 60" x 24" |
| XMG-5-A | "SPEEDING" (INSIDE ORANGE MIRROR) SIGN | 48" x 18" |
| XMG-5-B | "RECKLESS DRIVING" (INSIDE ORANGE MIRROR) SIGN | 48" x 18" |
| XMG-5-C | "ROAD CONSTRUCTION AHEAD" SIGN | 48" x 48" |
| XMG-5-D | DETOUR AHEAD SIGN | 48" x 48" |
| XMG-5-E | ROAD CLOSED AHEAD SIGN | 48" x 48" |

LEGEND

- ⓐ ROAD CLOSURE SIGN ASSEMBLY WITH TYPE "A" BARRICADE AND R11-2
- ⓑ ROAD CLOSURE SIGN ASSEMBLY WITH TYPE "B" BARRICADE AND R11-3
- ⓒ ROAD CLOSURE SIGN ASSEMBLY WITH TYPE "C" BARRICADE AND R11-3
- ⓓ ROAD CLOSURE SIGN ASSEMBLY WITH TYPE "D" BARRICADE AND R11-3
- ⓔ ROAD CLOSURE SIGN ASSEMBLY WITH TYPE "E" BARRICADE AND R11-3
- ⓕ ROAD CLOSURE SIGN ASSEMBLY WITH TYPE "F" BARRICADE AND R11-3
- ⓖ ROAD CLOSURE SIGN ASSEMBLY WITH TYPE "G" BARRICADE AND R11-3
- ⓗ ROAD CLOSURE SIGN ASSEMBLY WITH TYPE "H" BARRICADE AND R11-3
- ⓘ ROAD CLOSURE SIGN ASSEMBLY WITH TYPE "I" BARRICADE AND R11-3
- ⓙ ROAD CLOSURE SIGN ASSEMBLY WITH TYPE "J" BARRICADE AND R11-3
- ⓚ ROAD CLOSURE SIGN ASSEMBLY WITH TYPE "K" BARRICADE AND R11-3
- ⓛ ROAD CLOSURE SIGN ASSEMBLY WITH TYPE "L" BARRICADE AND R11-3
- ⓜ ROAD CLOSURE SIGN ASSEMBLY WITH TYPE "M" BARRICADE AND R11-3
- ⓝ ROAD CLOSURE SIGN ASSEMBLY WITH TYPE "N" BARRICADE AND R11-3
- ⓞ ROAD CLOSURE SIGN ASSEMBLY WITH TYPE "O" BARRICADE AND R11-3
- ⓟ ROAD CLOSURE SIGN ASSEMBLY WITH TYPE "P" BARRICADE AND R11-3
- ⓠ ROAD CLOSURE SIGN ASSEMBLY WITH TYPE "Q" BARRICADE AND R11-3
- ⓡ ROAD CLOSURE SIGN ASSEMBLY WITH TYPE "R" BARRICADE AND R11-3
- ⓢ ROAD CLOSURE SIGN ASSEMBLY WITH TYPE "S" BARRICADE AND R11-3
- ⓣ ROAD CLOSURE SIGN ASSEMBLY WITH TYPE "T" BARRICADE AND R11-3
- ⓤ ROAD CLOSURE SIGN ASSEMBLY WITH TYPE "U" BARRICADE AND R11-3
- ⓖ ROAD CLOSURE SIGN ASSEMBLY WITH TYPE "V" BARRICADE AND R11-3
- ⓗ ROAD CLOSURE SIGN ASSEMBLY WITH TYPE "W" BARRICADE AND R11-3
- ⓘ ROAD CLOSURE SIGN ASSEMBLY WITH TYPE "X" BARRICADE AND R11-3
- ⓙ ROAD CLOSURE SIGN ASSEMBLY WITH TYPE "Y" BARRICADE AND R11-3
- ⓚ ROAD CLOSURE SIGN ASSEMBLY WITH TYPE "Z" BARRICADE AND R11-3

| ITEM | TOTALS |
|---------------|--------|
| TYPE "A" SIGN | 2 EACH |
| R11-2 | 3 EACH |
| R11-3 | 1 EACH |
| XG20-2A | 1 EACH |
| XMG-5-A | 1 EACH |
| XMG-5-B | 1 EACH |
| XMG-5-C | 2 EACH |
| XMG-5-D | 2 EACH |
| XMG-5-E | 2 EACH |
| XMG-5-F | 2 EACH |
| XMG-5-G | 2 EACH |
| XMG-5-H | 2 EACH |
| XMG-5-I | 2 EACH |
| XMG-5-J | 2 EACH |
| XMG-5-K | 2 EACH |
| XMG-5-L | 2 EACH |
| XMG-5-M | 2 EACH |
| XMG-5-N | 2 EACH |
| XMG-5-O | 2 EACH |
| XMG-5-P | 2 EACH |
| XMG-5-Q | 2 EACH |
| XMG-5-R | 2 EACH |
| XMG-5-S | 2 EACH |
| XMG-5-T | 2 EACH |
| XMG-5-U | 2 EACH |
| XMG-5-V | 2 EACH |
| XMG-5-W | 2 EACH |
| XMG-5-X | 2 EACH |
| XMG-5-Y | 2 EACH |
| XMG-5-Z | 2 EACH |

SIDEWALK CLOSED
 R9-9
 24" x 12"

DETOUR
 XMG-10(L)
 48" x 18"

DETOUR
 XMG-10(R)
 48" x 18"

CONSTRUCTION SIGNS, TYPE "B"

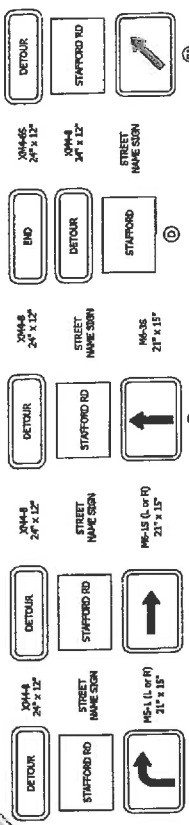

DETOUR ROUTE MARKER ASSEMBLY

DATE: _____

DRAWN BY: _____

CHECKED BY: _____

DESIGNED BY: _____

APPROVED FOR APPROVAL: _____

SCALE: _____

PROJECT: _____

SHEET: _____

CONTRACT: _____

INDIANA
 DEPARTMENT OF TRANSPORTATION
 MAINTENANCE OF TRAFFIC
 DETOUR MAP

